

Facsimile

## Quick Reference Guide

Model No. **KX-PW92CW**



Thank you for purchasing a Panasonic facsimile.

### Table of Contents

Finding the controls .....	2
Installations and connections .....	4
Setting the date and time .....	7
Setting your facsimile telephone number .....	7
Setting your logo .....	8
Character input and command key table .....	9
Automatic dialing on the main unit.....	10
Automatic dialing on the portable handset .....	11
Intercom between the main unit and portable handset .....	12
Sending faxes .....	13
Receiving faxes .....	14
Operating the built-in answering device .....	16
Individual e-mail services .....	18
Specifications.....	Back cover

- This guide explains some basic features and operations, but not all of them. For further details, see the Japanese operating instructions.
- This product is designed for use in Japan.  
Panasonic cannot provide service for this product if used outside Japan.
- Any details given in this guide are subject to change without notice.

# Finding the controls

## Main unit (control panel)

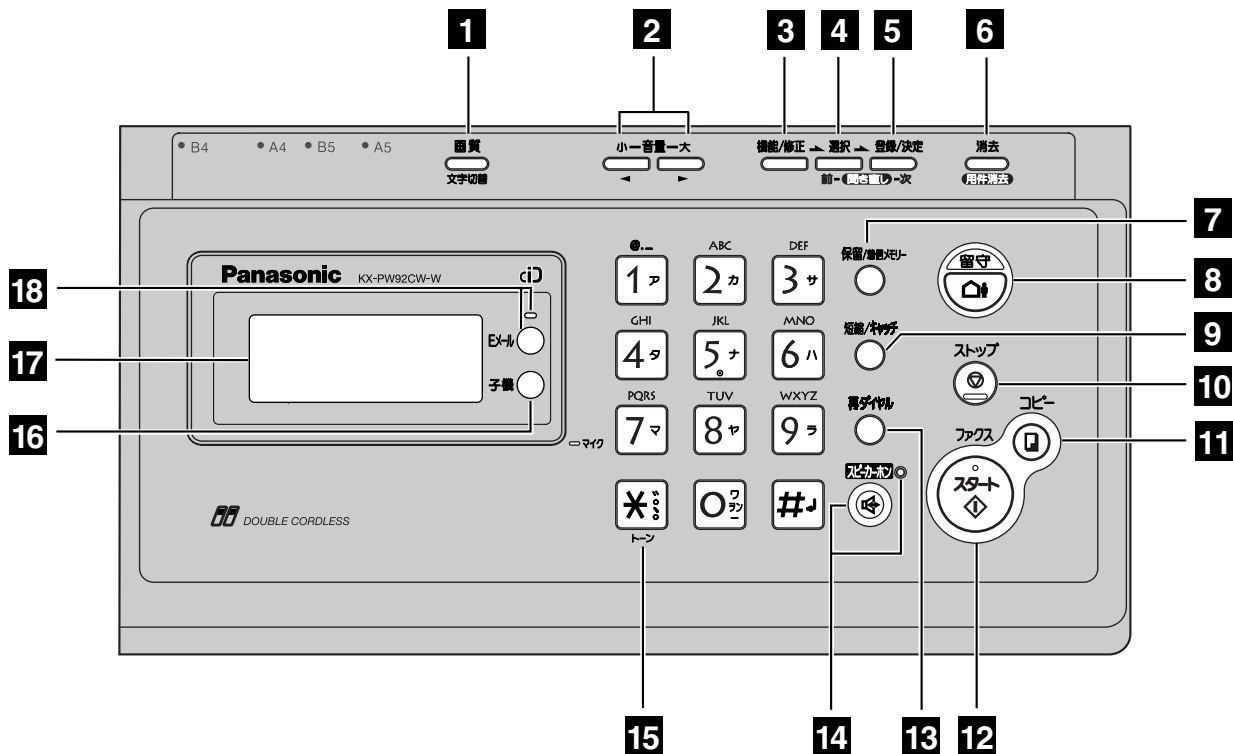

**1 Resolution** button selects the resolution when faxing or copying.

**Character Input Mode** button

**2 Volume** buttons adjust ringer, speaker and handset volume by pressing the up and down buttons.

**3 Function** button initiates programming.  
**Edit** button

**4 Select** button selects feature settings.  
**Previous Replay** button  
—plays back recorded messages.  
—returns to the previous message while listening to a recorded message.

**5 Register/Set** button stores a parameter.  
**Next Replay** button  
—plays back recorded messages.  
—skips to the next message while listening to a recorded message.

**6 Erase** button

**7 Hold** button

**Call Memory** button starts a search in the Number Display log.  
(For caller ID display service users.)

**8 Auto Answer** button & indicator  
—light on: answering device activated.  
—light off: used as a regular telephone.

**9 Speed Dialer** button

**Flash** button  
(For call waiting service users.)

**10 Stop** button

**11 Copy** button starts copying.

**12 Start/Fax** button starts faxing.

**13 Redial** button

**Pause** button

**14 Speakerphone** button & indicator

**15 Tone** button switches to tone dialing.

**16 Portable Handset** button

**17 Liquid crystal display**

**18 E-Mail** button & indicator

# Finding the controls

## Portable handset

**How to use key**

- 電話帳 To use the phonebook.
- 再ダイヤル To redial the last number dialed.  
To insert a pause.
- 音量 To adjust the volume.

**外線** To make/answer calls.

**文字切替** To page the main unit.  
**内線** To change the character input mode.

- 切 To end a call.  
To end or exit from editing or other operations.
- 保留 To put a call on hold.  
To start a search in the Number Display log. (For caller ID display service users.)
- 音量 To adjust the volume.

**クリアー** To clear letters/numbers. For call waiting service users.

**ファクス** To receive faxes.

**スピーカホン** To use the speakerphone.

増設 Used when installing additional portable handsets.

**Speaker**

**LCD (with back light)**

Displays battery strength, telephone numbers etc.

① ..... Portable handset number

② ..... Function menu that is controlled by **F1** or **F2**.

③ ..... Battery strength

**How to use **F1** **F2** buttons**

**F1** and **F2** buttons refer to the function displayed on the bottom of the display. They function differently depending on the mode.

**Dial buttons**

- トーン \* Tone button To switch to Tone dialing mode.
- # Sharp button

**Charge indicator**

Charging ..... Red

Full ..... Off

**Microphone**

( Do not cover the microphone while talking. )

# Installations and connections

## Installing the ink film

- 1 Open the control panel.



- 2 Open the control panel until it locks.

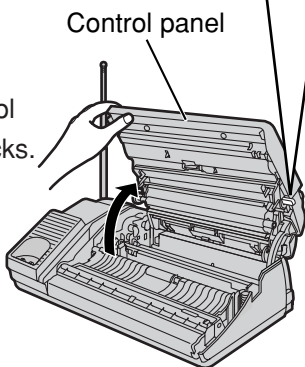

- 2 Insert the ink film.

Find the "T" shaped gear (blue).

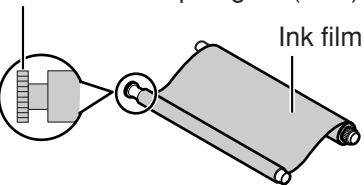

- 1 Insert the blue core into the right slot of the main unit.

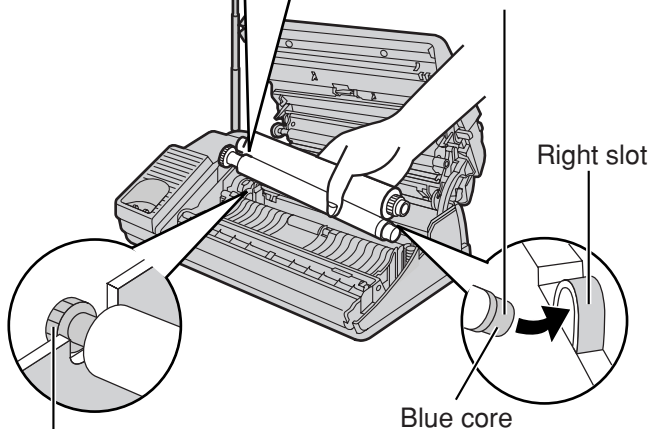

- 2 Insert the "T" shaped gear (blue) into the left slot of the main unit.

- 3 Insert the white core into the slots.

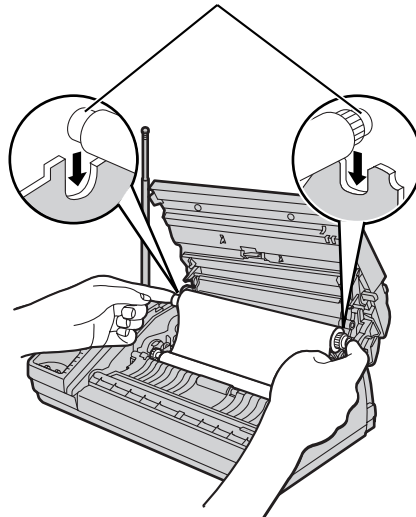

- 3 If the ink film is slack, tighten it by winding the "T" shaped gear.

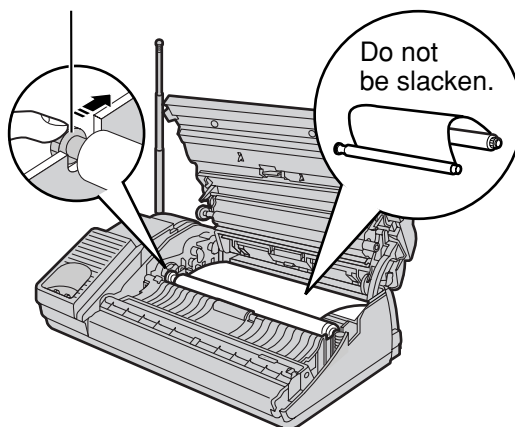

- 4 Close the control panel until it locks.

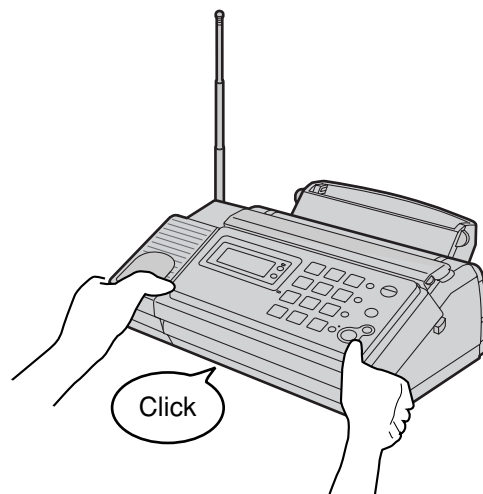

# Installations and connections

## Installing recording paper (A4 size)

**1** Install the recording paper tray.

- ① Separate the recording paper cover from the recording paper tray.

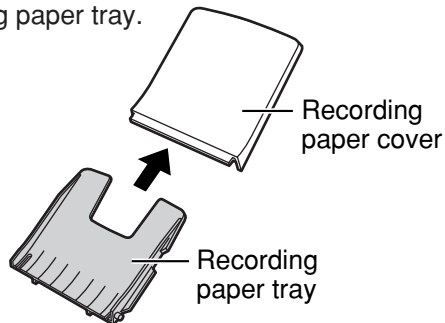

- ② Insert the left tab on the recording paper tray into the left slot of the main unit.

- ③ Insert the right tab into the right slot of the main unit.

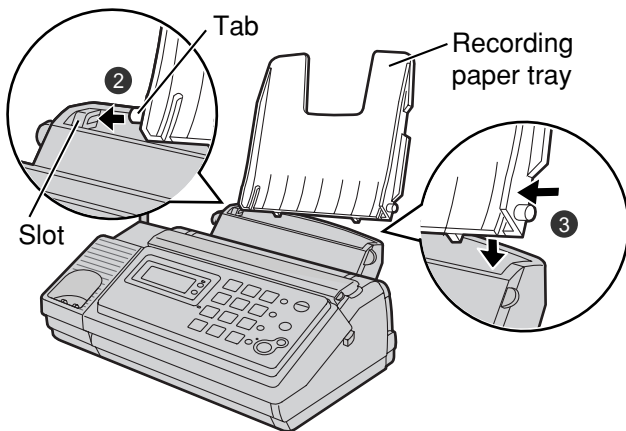

**2** Insert the recording paper into the recording paper tray.

- ① Open the paper entrance cover until it locks.

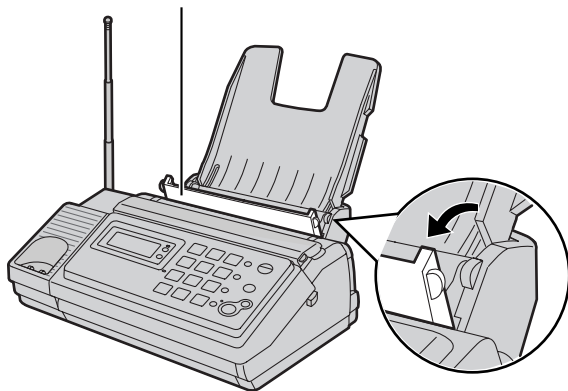

- ② Fan the stack of recording paper (A4 size).

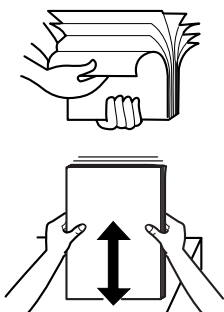

- ③ Insert the recording paper into the recording paper tray. (Up to 30 sheets)

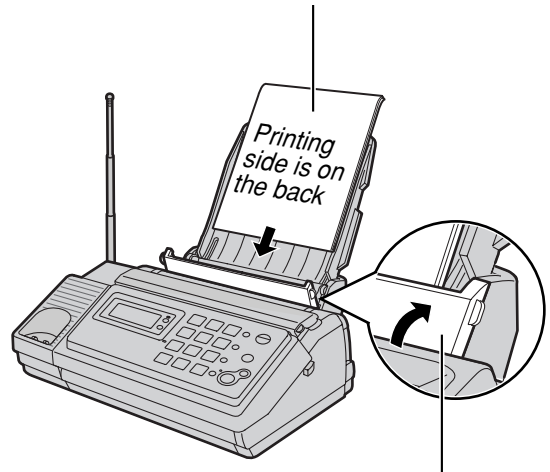

- ④ Close the paper entrance cover by leaning it back.

**3** Install the recording paper cover on the recording paper tray by sliding it down from the top.

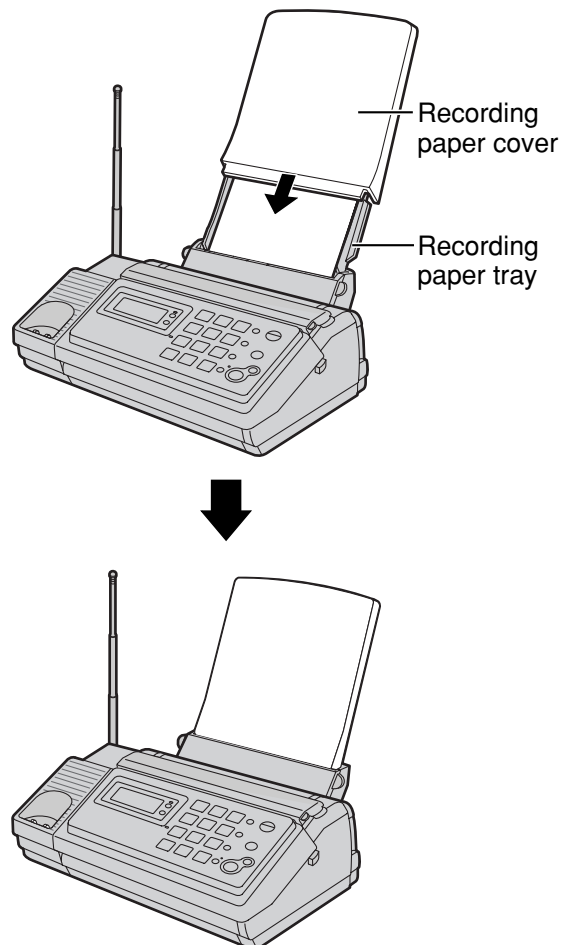

# Installations and connections

## Connecting the main unit

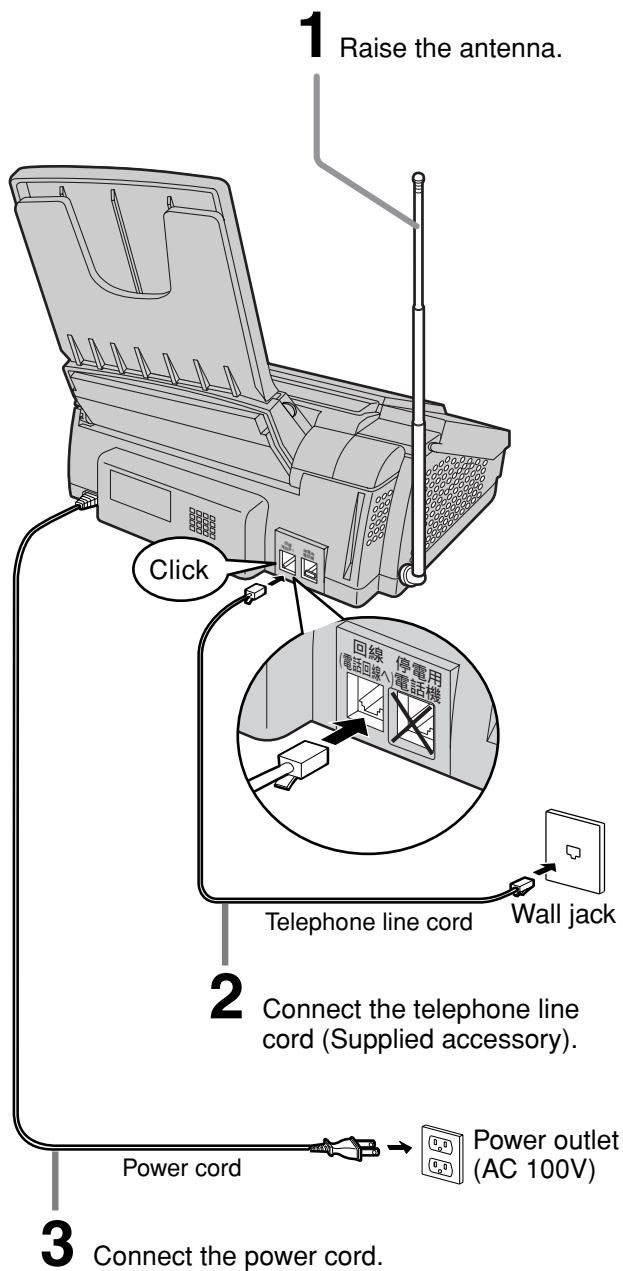

### After the Power On...

This unit will automatically select the dialing mode (Tone/Pulse).

## Setting up the portable handset

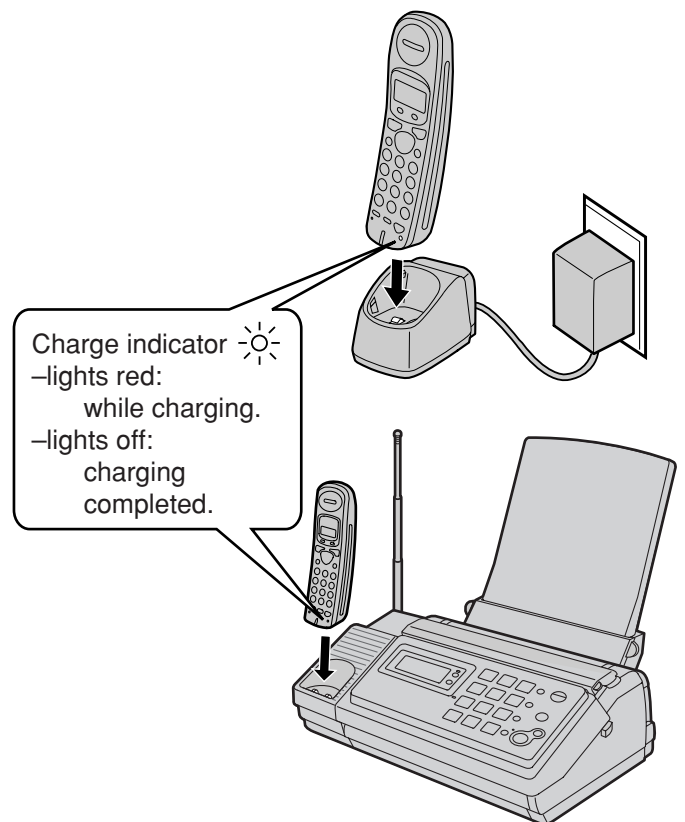
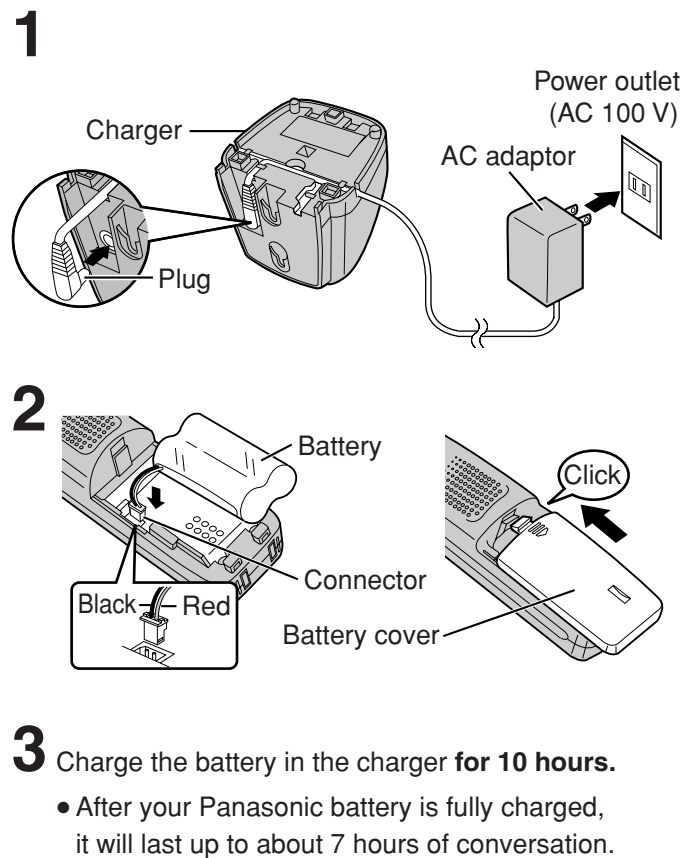

# Setting the date and time

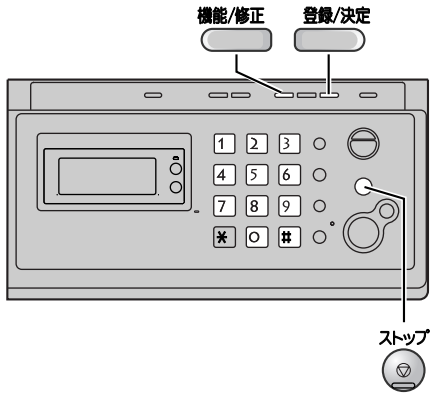

**1** Open the document cover and press **機能/修正** (Function/Edit).

キノウ トウロク モード  
[センタク] オス

**2** Press **# 0 0 1**.

Example :

2003年06月01日  
20:10  
Cursor

**3** Enter the correct year/month/day.

Example: **October 1, 2003**

Press **2 0 0 3 1 0 0 1**.

2003年10月01日  
20:10

**4** Enter the correct hour/minute in a 24-hour clock entry.

Example: **15:45 (3:45 PM)**

Press **1 5 4 5**.

2003年10月01日  
15:45

**5** Press **登録/決定** (Register/Set).

トウロク シマシタ



2003年10月01日  
15:45

**6** Press **ストップ** (Stop).

Example :

10月 1日 15:45  
ヨウケン ロクオン 00ケン

# Setting your facsimile telephone number

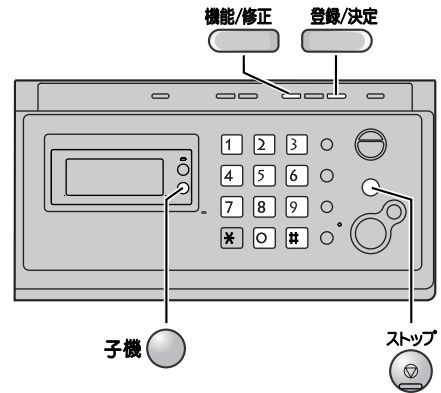

**1** Open the document cover and press **機能/修正** (Function/Edit).

キノウ トウロク モード  
[センタク] オス

**2** Press **# 0 0 4**.

アナタノテ`ソウハ`ソコ`ウ?  
TEL=. . . . .  
Cursor

**3** Enter your facsimile telephone number, up to 20 digits.

Example: **098 765 43 ..**

アナタノテ`ソウハ`ソコ`ウ?  
TEL=8 765 43 ..

The **子機** (Space) button replaces the digit with a space.

**4** Press **登録/決定** (Register/Set).

トウロク シマシタ



アナタノテ`ソウハ`ソコ`ウ?  
TEL=0 98 765 43 .

**5** Press **ストップ** (Stop).

Example :

10月 1日 15:45  
ヨウケン ロクオン 00ケン

# Setting your logo

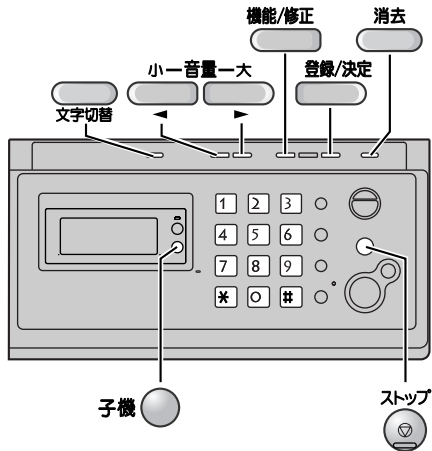

**1** Open the document cover and press **機能/修正** (Function/Edit).

キノウ トウロク モード  
[センタク] オス

**2** Press **# 0 0 2**.

ナマエ?  
Cursor

**3** Enter your logo, up to 30 characters, using the dial keypad.

- To enter English characters easily, press **文字切替** (Character input mode) repeatedly and select “英” (English and sign input mode).
- For details, see the table on page 9 for instructions.

## Example: Micah

1. Press **6** once.

ナマエ?  
M  
Cursor

2. Press **4** six times.

ナマエ?  
Mi

3. Press **2** six times.

ナマエ?  
Mic

4. Press **音量一大** to move the cursor to the next space and press **2** four times.

ナマエ?  
Mic a

5. Press **4** five times.

ナマエ?  
Micah

**4** Press **登録/決定** (Register/Set).

トウロク シマシタ



ナマエ?  
Micah









**5** Press **ストップ** (Stop).



**Example :** 10月 1日 15:45  
ヨウケン ロクオン 00ケン

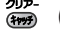

# Character input and command key table

Pressing the dial keys will select a character as shown below.

Character		Katakana	English	Numbers
Display of the main unit		カナ	英	数
Display of the portable handset		[ カナ ]	[ AB ]	[ 12 ]
Dial key				
(Portable handset)	(Main unit)			
①	1	アイウエオアイウエオ	@ . _ - & \$ ¥ % + = ~ ^	1
②	2	カキクケコ	A B C a b c	2
③	3	サシスセソ	D E F d e f	3
④	4	タチツテトツ	G H I g h i	4
⑤	5	ナニヌネノ	J K L j k l	5
⑥	6	ハヒフヘホ	M N O m n o	6
⑦	7	マミムメモ	P Q R S p q r s	7
⑧	8	ヤユヨヤユヨ	T U V t u v	8
⑨	9	ラリルレロ	W X Y Z w x y z	9
○	○	ワヲンー!? ( )	! ? / - * # , ; :   . ' " ( ) [ ] { } 「 」	0
✳	✳	ゝ っ っ っ	ゝ っ っ っ	
Command keys		 (Portable handset),  (Main unit)	Used to change the character input mode.	
		 (Portable handset),  (Main unit)	Used to move the cursor to the left and right.	
		 (Portable handset),  (Main unit)	Used to delete a character.	
		 (Portable handset),  (Main unit)	Used to insert a space.	

- When entering e-mail address, the small letters are displayed before the capital letters.
- When entering e-mail address, you can not enter the following symbols: 
- When entering e-mail address, you can enter only English and Numbers.
- When entering e-mail message, pressing  enables you to begin the new line. ( “ ↵ ” is displayed.)
- The display items of the main unit are somewhat different from that of the portable handset.

# Automatic dialing on the main unit

## Storing telephone numbers in the speed dialer

You can store up to 9 stations.  
The dialing buttons (1 to 9) function as memory stations.

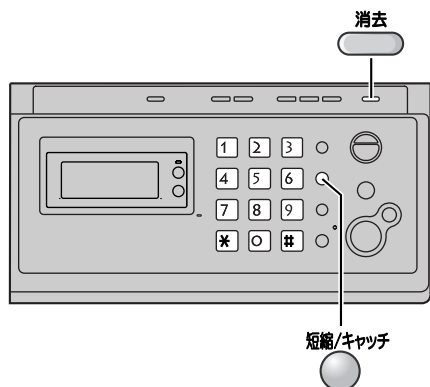

**1** Press  (Speed dialer).

**2** Press the memory station number (1 to 9).

タンシユク 1  
トウロク サレテ イマセン



タンシユク 1 トウロク  
ハンゴウ?

Memory station number

**3** Enter the telephone number, up to 30 digits.  
• To correct a mistake, press  (Clear).

**4** Press  (Speed dialer).

## Making a voice call using the speed dialer

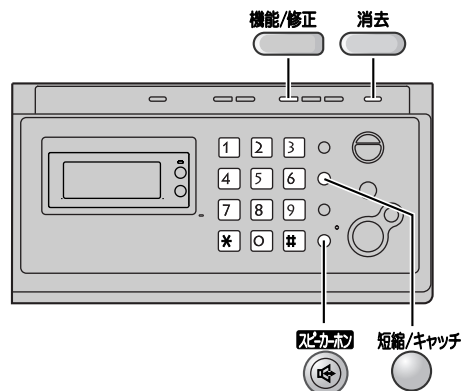

**1** Press  (Speed dialer).

**2** Press the memory station number (1 to 9).

**3** Press  (Speakerphone).

## Editing a stored number in the speed dialer

**1** Press  (Speed dialer).

**2** Press the memory station number (1 to 9).

**3** Press  (Function/Edit).

**4** Edit the telephone number.

**5** Press  (Speed dialer).

## Erasing a stored number in the speed dialer

**1** Press  (Speed dialer).

**2** Press the memory station number (1 to 9).

**3** Press  (Erase).

**4** Press .

# Automatic dialing on the portable handset

## Storing names and telephone numbers in the phonebook

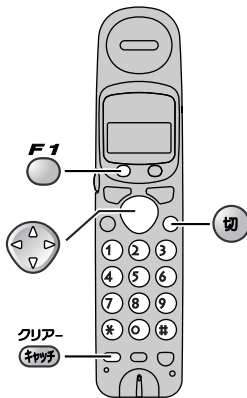

1 Press (Phonebook).

テ`ンワチョウ ケンサク  
ナマエ? [カナ]



ケンサクハ  
[ ]オス

2 Press (Register).

- “XXX” shows the remaining station numbers you can store.

テ`ンワチョウ トウロク  
アキ x x xケン



ナマエ? [カナ]

- You can program up to 100 stations, including 4 pre-programmed stations.

3 Enter the name, up to 12 characters (see the table on page 9 for instructions).

4 Press (Register).

5 Enter the telephone number, up to 30 digits.

- To correct a mistake, press (Clear).

6 Press (Register).

- To program other items, repeat steps 3 to 6.

7 Press (Off) to exit the program.

## Making a voice call using the phonebook

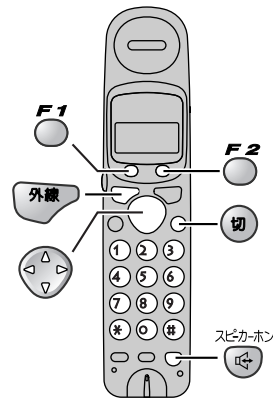

1 Press (Phonebook).

2 Press (Search button) repeatedly until the desired name is displayed.

3 Press (Talk) or press (Speakerphone).

## Editing a stored name or number

1 Press (Phonebook).

2 Press (Search button) repeatedly until the desired name is displayed.

3 Press (Edit).

4 Press .

5 Edit the name (see the table on page 9 for instructions).

- If you do not need to edit the name, skip to step 6.

6 Press (Register).

7 Enter the correct telephone number.

- If you do not need to edit the telephone number, skip to step 8.

8 Press (Register).

# Intercom between the main unit and portable handset

An intercom is available between the main unit and portable handset.

## Using the main unit:

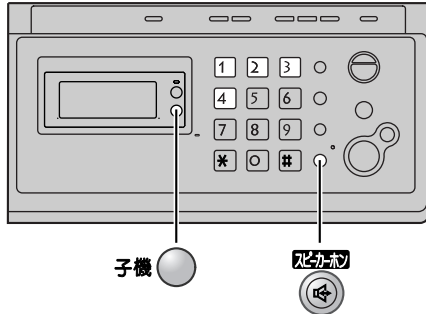

- 1 Press 子機 (Portable handset), then press the portable handset number (1 to 4) which you want to call.
- 2 Start talking using the speakerphone.  
コキ1 ナイセンツウワ チュウ
- 3 Press スピーカホン (Speakerphone) to end the intercom call.

## Using the portable handset:

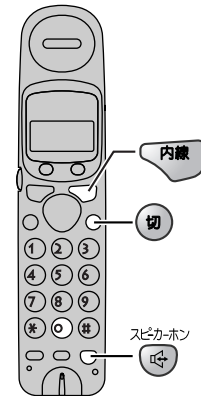



- 1 Press 内線 (Intercom), then press 切 .
- 2 Start talking after the unit sounds "Pi peep" and shows the following.
  - You can switch to the speakerphone by pressing ナイセンツウワ チュウ  
スピーカホン (Speakerphone).
- 3 Press 切 (Off) to end the intercom call.

# Sending faxes

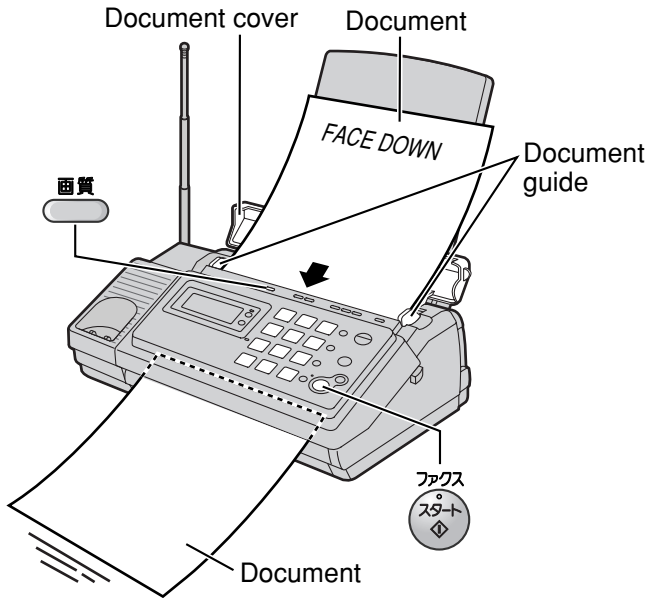

## Sending a fax manually

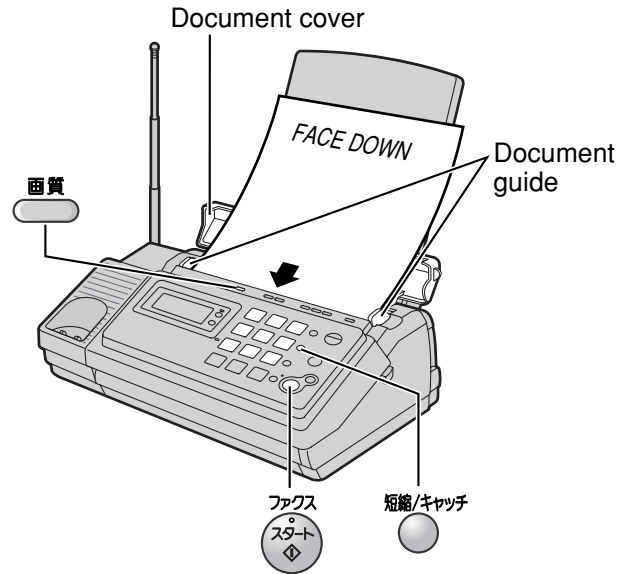

- 1 Open the document cover, and adjust the width of the document guides to the size of the document.
- 2 Insert the document (up to 5 pages) FACE DOWN until a single beep is heard.
- 3 If necessary, press  (Resolution) repeatedly to select the desired setting (see below).
- 4 Dial the fax number.
- 5 Press  (Fax).
  - The unit will start fax transmission.

## Sending a fax using the speed dialer



- 1 Open the document cover, and adjust the width of the document guides to the size of the document.
- 2 Insert the document (up to 5 pages) FACE DOWN until a single beep is heard.
- 3 If necessary, press  (Resolution) repeatedly to select the desired setting (see below).
- 4 Press  (Speed dialer), then press the memory station number (1 to 9).
- 5 Press  (Fax).
  - The unit will start fax transmission.

### To select the resolution

Select the desired resolution according to the type of document, by pressing  (Resolution).

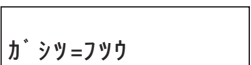
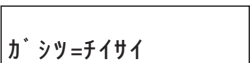
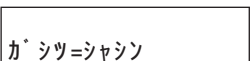
- |                                                                                              |                                                                               |
|----------------------------------------------------------------------------------------------|-------------------------------------------------------------------------------|
|  カ シツ=フツウ  | (Standard) for printed or typewritten originals with normal-sized characters. |
|  カ シツ=チイサイ | (Fine) for originals with minute printing.                                    |
|  カ シツ=シャシン | (Photo) for originals containing photographs.                                 |

# Receiving faxes

## Receiving a fax manually (AUTO ANSWER off)

Using the main unit:

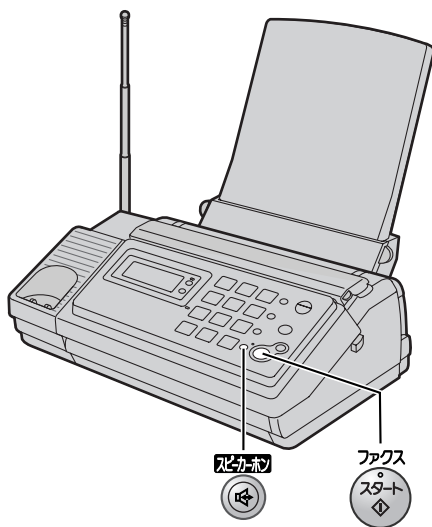

**1** When you hear a ring, press  (Speakerphone) to answer the call.

**2** When:  
– document reception is required,  
– a fax calling tone (slow beep) is heard, or  
– no sound is heard,

press  (Fax).

- The unit will start fax reception.

Using the portable handset:

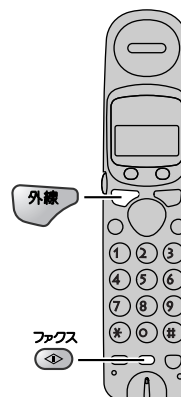



**1** When you hear a ring, lift the portable handset from the charger to answer the call.  
• If the portable handset is not set on the charger, press  (Talk).

**2** When:  
–document reception is required,  
–a fax calling tone (slow beep) is heard, or  
–no sound is heard,  
press  (Fax reception).  
• The main unit will start fax reception.

# Receiving faxes

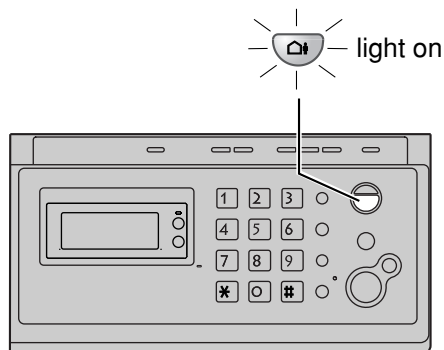
## Receiving a fax automatically (AUTO ANSWER on)



**1** If the  (Auto answer) light is off, turn it on by pressing .

**2** When receiving a call, the unit will receive a fax document or record a voice message automatically depending on the caller's request.

## Recording your own greeting message

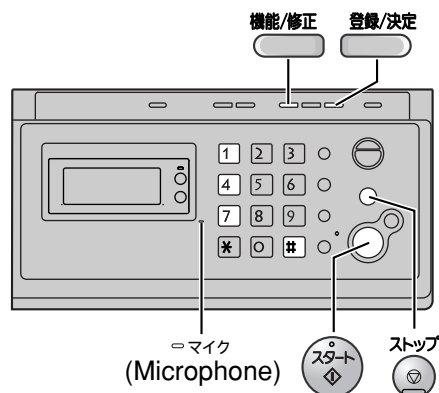

You can record your own greeting message. When receiving a call, it will be played to callers instead of the pre-recorded Japanese greeting message.

**1** Press  (Function/Edit).

**2** Press    .

シ' サク オウトウ ロクオン  
[ケッテイ] オス

**3** Press  (Register/Set).

**4** Press  (Start) and speak your greeting message, up to 16 seconds, to the microphone.

**5** Press  (Stop).

- Your greeting message will be played back automatically.

# Operating the built-in answering device

## Activating the answering device

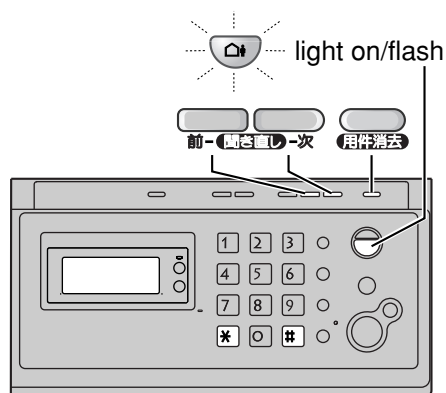

- 1 Turn the (Auto answer) light on by pressing .
- 2 When receiving a call, a greeting message will be played and the unit will record a voice message.
  - To record your own greeting message, see page 15.

## Listening to recorded messages

When new messages are recorded, the (Auto answer) light will flash.

Press to listen to recorded messages.

After the messages are played back, the following will be displayed.

- To erase the messages, push . サイセイシタヨウケンショウキヨ  
スル=＊シナイ=#
- To save the messages, push .

## Listening to all of the recorded messages

Press or (Replay).

After the messages are played back, the following will be displayed.

- To erase the messages, push . サイセイシタヨウケンショウキヨ  
スル=＊シナイ=#
- To save the messages, push .

## Erasing a specific message

Press (Erase) while listening to the message you want to erase, then press .

## Erasing all of the recorded messages

- 1 Press (Erase).

スハテ ショウキヨシマスカ?  
ハイ=＊ イイエ=#

- 2 Press .

## Erasing your own greeting message

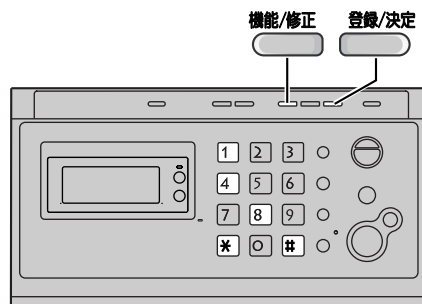

- 1 Press (Function/Edit).

- 2 Press .

シ`サク オウトウ ショウキヨ  
[ケッテイ] オス

- 3 Press (Register/Set).

- 4 Press .





- The pre-recorded Japanese greeting message will be played when you receive a call.



# Operating the built-in answering device

## Operating the answering device from a remote location

### Preparation: Programming the remote operation ID

1. Press  (Function/Edit).
2. Press    .
3. Enter any 4-digit number (remote operation ID) except \* or #.

**Example :**

アソシヨウ No. = 1234
[ 4ケタ, トウロク ] オス

4. Press  (Register/Set).
5. Press  (Stop).

### Operation: Listening to a recorded message from a remote location

Turn the  (Auto answer) light on before you go out. Remote operations are available only from a touch tone telephone.

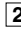
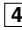
1. Call your unit.
2. Enter the remote operation ID during the greeting message.
3. Press  or wait 4 seconds.
  - Only the new recorded messages will be played back.
  - To listen to all the recorded messages, press  after the new messages have been played back.

# Individual e-mail services

## Using the e-mail services

Panasonic Communications Co., Ltd. (hereafter called "PCC") offers individual information services, such as e-mail.

Your fax machine with e-mail features will enable you to send an e-mail to another party's personal computer (PC) or another e-mail fax machine anywhere in the world through the Internet. Also, you will be able to receive an e-mail from them.

To access the Internet using your fax machine,

- you need a credit card (VISA, JCB or MASTER as of January 2003) and
- have to subscribe to individual information services offered by PCC beforehand.

The application fee including call charges will be charged to your Credit Card.

### Important:

- If your fax machine is connected to a home telephone system or a private branch exchange (PBX) system, these services are not available.

### Application fee and call charges

PCC information services	Registration fee	¥500
	Information Service fee (Call charge included)	¥20/minute (8 am-11 pm) ¥18.5/minute (11 pm-8 am)

- As of January 2003.
- Tax not included.

## PCC information services

The following services are available with your fax machine. The information service fee including the call charge will be applied.

- E-mail reception and printing (page 20)
- Text e-mail sending (page 21)
- Fax e-mail sending (page 22)
- Storing e-mail addresses in the speed dialer (free of charge) (page 23)
- Others

### Note:

- PCC plans to add new information services and the information service fee is subject to change. PCC will announce them by e-mail to its customers.
- For the PC user to view your fax e-mail sent from your fax machine, the following PC software will be required.
  - E-mail software that can read the MIME format
  - TIFF viewer software

# Individual e-mail services

## Subscribing to PCC information services

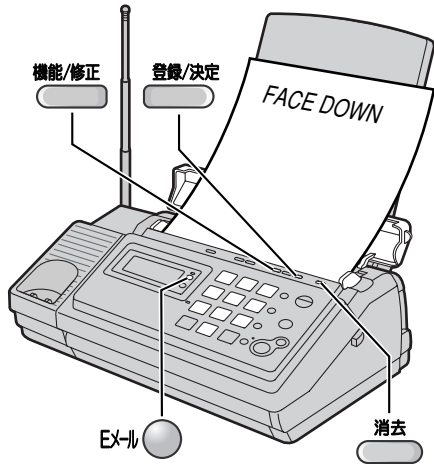

**1** Fill in the included application form.

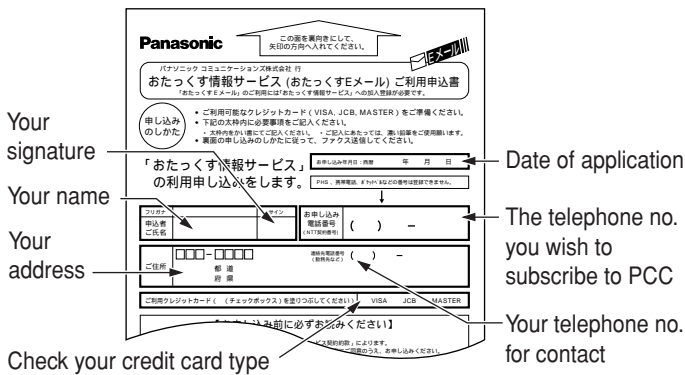

**2** Press **機能/修正** (Function/Edit), then press **EX-FL** (E-mail).

**3** Press **登録/決定** (Register/Set).

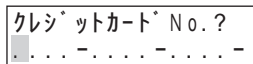

**4** Enter your 16-digit credit card number.

- To correct a mistake, press **消去** (Clear).

**5** Press **登録/決定** (Register/Set).

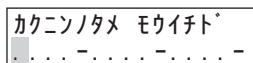

**6** Enter your credit card number again, then press **登録/決定** (Register/Set).

**7** Enter the valid date of your credit card.

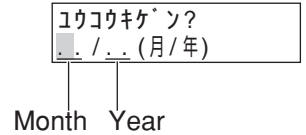

**8** Press **登録/決定** (Register/Set).

**9** Insert the application form FACE DOWN.

**10** Press **登録/決定** (Register/Set).

- The unit will start fax transmission.

**11** After approx. 5 minutes, the unit will ring, and a data communication will start automatically between your unit and PCC.

- If you answer this call, wait for a while until the communication is completed.

**12** When the communication is completed, a user registration form will be printed.

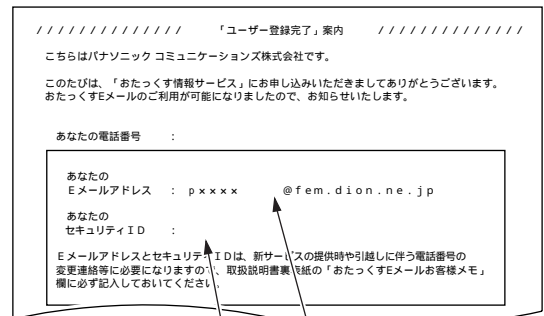

Your e-mail address  
Your security ID code

- Please save the address and ID code for future reference.

**13** Press **EX-FL** (E-mail).

**14** Press **登録/決定** (Register/Set).

- An information service guide will be printed.

# Individual e-mail services

## Receiving and printing an e-mail

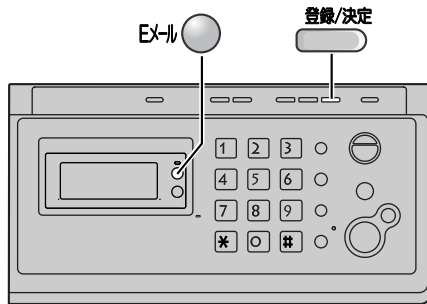

**1** Press **Eメール** (E-mail) .

**2** Press **登録/決定** (Register/Set).

- If there is an e-mail you have not viewed yet, the unit will print the received e-mail.
- If there is no e-mail, the following will be displayed.

メッセージEメール 0ケン

**The file formats recognized by your fax machine are:**

- JPEG      • ~. doc
  - TIFF      • ~. xls
  - BMP      • ~. ppt
  - TXT      • ~. pdf
- (as of January 2003)

# Individual e-mail services

## Sending a text e-mail from the main unit

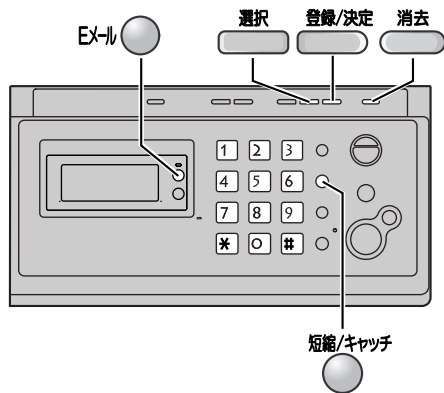

**1** Press **Eメール** (E-mail).

**2** Press **選択** (Select).

モジ\* Eメール ソウジン  
[ケッテイ] オス

**3** Press **登録/決定** (Register/Set).

**4** Enter the desired e-mail address (see the table on page 9 for instructions).

- You can select the desired address using the speed dialer.

1. Press **短縮/キャッチ** (Speed dialer), then press the memory station number (**1** to **9**).

2. Press **登録/決定** (Register/Set).

To store an address, see page 23.

**5** Press **登録/決定** (Register/Set).

- The display will show the last title you entered.

To delete this title, press **消去** (Clear) for 2 or more seconds.

**6** Enter the title of your e-mail, up to 32 characters (see the table on page 9 for instructions).

**7** Press **登録/決定** (Register/Set).

- The display will show the last message you entered. To delete this message, press **消去** (Clear) for 2 or more seconds.

**8** Enter your e-mail message, up to 200 characters (see the table on page 9 for instructions).

**9** Press **登録/決定** (Register/Set).

# Individual e-mail services

## Sending a fax e-mail

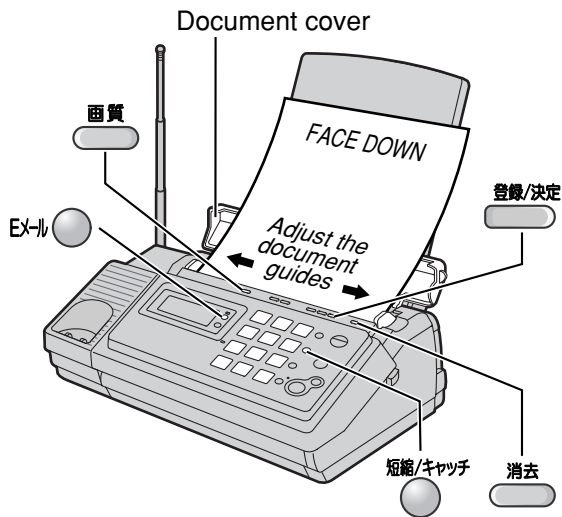

- 1** Open the document cover, and adjust the width of the document guides to the size of the document.
- 2** Insert the document (up to 5 pages) FACE DOWN until a single beep is heard.
- 3** If necessary, press **函質** (Resolution) repeatedly to select the desired setting (see page 13).
- 4** Press **Eメール** (E-mail), then press **登録/決定** (Register/Set).
- 5** Enter the desired e-mail address (see the table on page 9 for instructions).
  - You can select the desired address using the speed dialer.
  1. Press **短縮/キャッチ** (Speed dialer), then press the memory station number (**1** to **9**).
  2. Press **登録/決定** (Register/Set).To store an address, see page 23.
- 6** Press **登録/決定** (Register/Set).
  - The display will show the last title you entered.To delete this title, press **消去** (Clear) for 2 or more seconds.

**7** Enter the title of your fax e-mail, up to 32 characters (see the table on page 9 for instructions).

**8** Press **登録/決定** (Register/Set).

# Individual e-mail services

## Storing e-mail addresses in the speed dialer

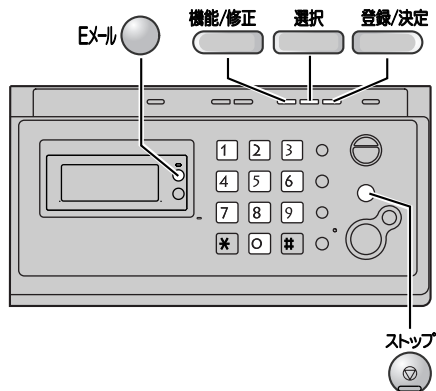

- 1 Press **機能/修正** (Function/Edit), then press **EX-ル** (E-mail).
- 2 Press **選択** (Select).  

タンシュク アト <sup>レ</sup> レス [ケッテイ]オス
--------------------------------------
- 3 Press **登録/決定** (Register/Set).  

タンシュク アト <sup>レ</sup> レス [1-9]ヲオシテクダ <sup>サ</sup> サイ
---------------------------------------------------------
- 4 Press the memory station number (2 to 9).
  - You can program up to 9 stations, including 1 pre-programmed stations.
- 5 Enter the e-mail address, up to 60 characters (see the table on page 9 for instructions).
- 6 Press **登録/決定** (Register/Set).
  - To program other items, repeat 4 to 6.
- 7 Press **ストップ** (Stop) to exit the program.

## Editing a stored e-mail address

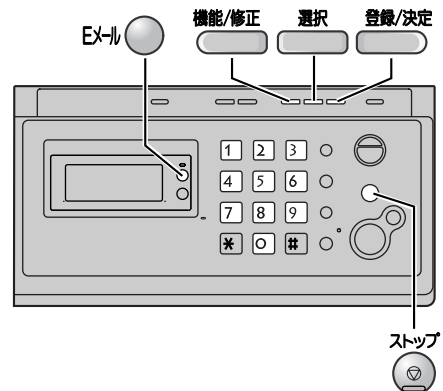

- 1 Press **機能/修正** (Function/Edit), then press **EX-ル** (E-mail).
- 2 Press **選択** (Select).
- 3 Press **登録/決定** (Register/Set).
- 4 Press the memory station number (1 to 9).
- 5 Press **機能/修正** (Function/Edit).
- 6 Edit the e-mail address (see the table on page 9 for instructions).
- 7 Press **登録/決定** (Register/Set).
- 8 Press **ストップ** (Stop) to exit the program.

# Specifications

KX-PW92CW	Main unit	Portable handset	Battery charger
<b>Power supply</b>	AC 100 V (50 Hz/60 Hz)	Ni-Cd battery (Part no. KX-FAN37) DC 2.4 V, 600 mAh	AC adaptor (Part no. PFAP1009) AC 100 V (50 Hz/60 Hz) DC 7.5 V, 100 mA
<b>Power consumption</b>	Transmission: Approx. 16 W Reception: Approx. 20 W Copy: Approx. 20 W Stand by: Approx. 1.4 W (Portable handset on cradle) Approx. 0.9 W (Portable handset off cradle) Maximum(*1): Approx. 125 W		• Charging: Approx. 1.1 W • Stand by: Approx. 0.4 W
<b>Dimensions (H x W x D)</b>	Approx. 139 X 358 X 253 mm (without projections) Approx. 378 X 358 X 300 mm (recording paper tray installed, without projections)	Approx. 181 X 44 X 40 mm	Approx. 72 X 72 X 90 mm
<b>Mass (Weight)</b>	Approx. 3.7 kg (10 m ink film installed)	Approx. 170 g (battery installed)	Approx. 77 g
<b>Operating environment</b>	5 °C – 35 °C, 45 % – 85 % RH (Relative Humidity)		

KX-PW92CW	Main unit
<b>Applicable line</b>	Public Switch Telephone Network (Tone/Pulse), F-Net, NCC Lines
<b>DC resistance</b>	320 Ω (*2)
<b>Compatibility</b>	G3 compatible
<b>Document size</b>	B4-A5(Max.257 mm in width, Max. 800 mm in length)
<b>Effective scanning size</b>	252 mm (B4) 208 mm (A4)
<b>Effective printing size</b>	202 mm (A4 size plain paper)
<b>Transmission time</b>	Approx. 15 s/page (Original mode) (*3)
<b>Modem speed</b>	9,600 / 7,200 / 4,800 / 2,400 bps; Automatic fallback
<b>Halftone level</b>	64-level
<b>Scanning density</b>	Horizontal: 8 pels/mm Vertical: 7.7 lines/mm (Fine/Photo), 3.85 lines/mm (Standard)
<b>Scanner type</b>	Contact image sensor
<b>Printer type</b>	Thermal transfer printing on plain paper
<b>Data compression system</b>	Modified Huffman (MH), Original mode
<b>Recording paper size</b>	A4: 210 mm x 297 mm (Plain paper)
<b>Answering device</b>	Greeting message: Digital recording system (up to 16 sec) Pre-recording greeting message ICM Recording: Digital recording system (Approx. 18 min. in total) (*4)
<b>Memory capacity</b>	Max. Approx. 46 pages (Only receiving fax etc.) (*5) Max. Approx. 18 min. (Only Recording message) (*4)

\*1 When copying a 100% black document.

\*2 If you cannot make a call due to DC resistance, consult your dealer.

\*3 Transmission speed is based on an A4-size document of 700 characters sent in standard resolution at 9,600 bps. The actual transmission speed depends upon the contents of the page, resolution, telephone line conditions and capability of the other party's machine.

\*4 If there is a silent pause, the total recording time will be longer.

\*5 The memory capacity is based on an A4-size document of 700 characters.